

T4S R65W SEC 18 1977-07

Revisions				
CODE	DATE	CASE	FROM	TO
001	08/07/61			A-1
002	02/18/64	64-54	A-1	A-2
003	03/02/71	70-34	A-1	R-A
004	03/19/73	72-50	A-1	O
005	06/16/86	AO 1985-251	A-1, R-A	AURORA
006	09/18/86	AO 1985-260	A-1, O	AURORA
007	09/09/03	AO 2001-096	R-A	AURORA
008	09/09/03	AO 2001-097	A-1	AURORA
009	12/06/05	L05-006		LE
010	09/11/06	AO 2005-90	A-1, O	AURORA
011	08/16/16	L16-003		LE

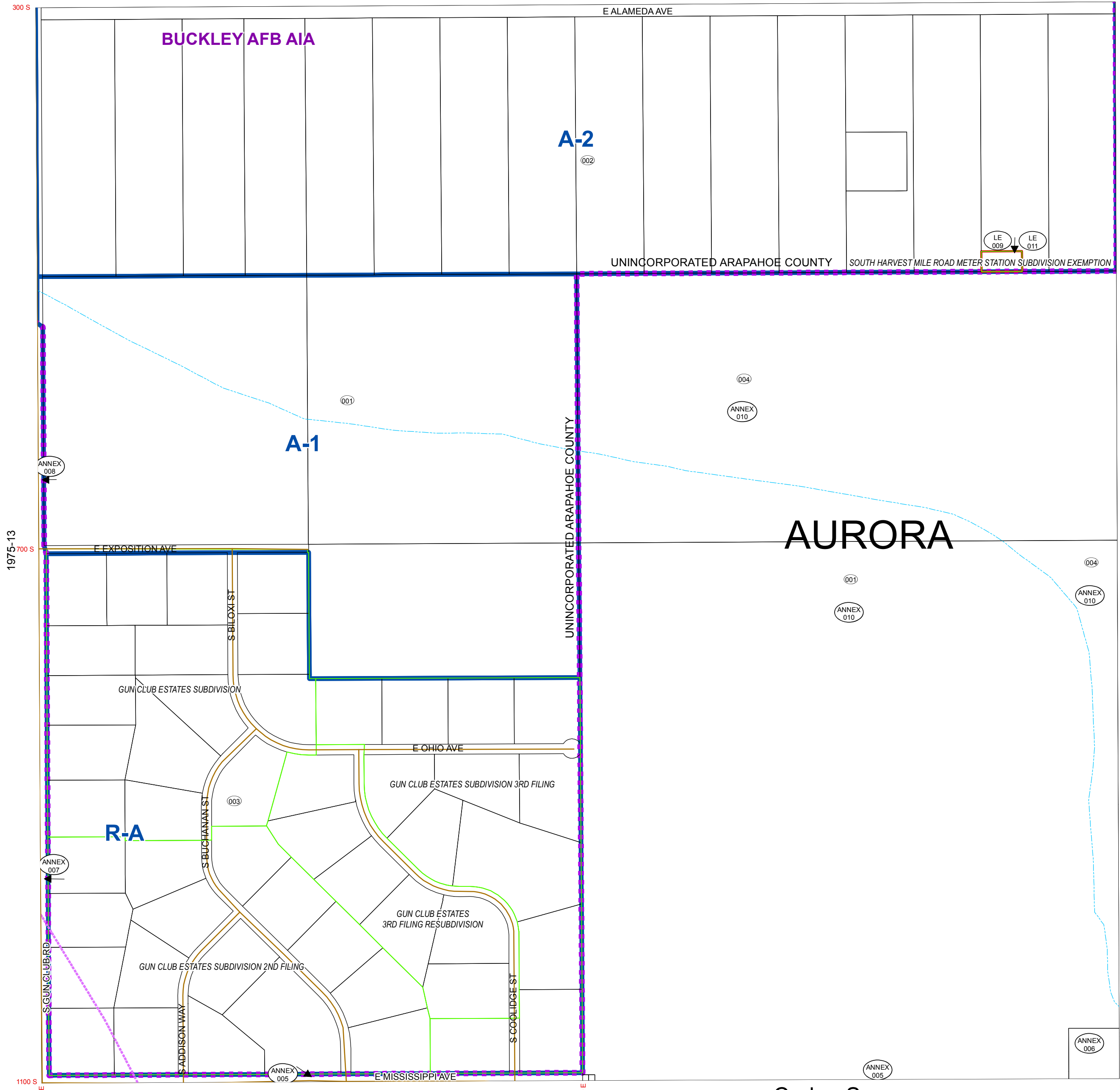

Code Sec  
1977 18

Date Saved: 4/14/2017 9:16:39 AM

General Disclaimer:  
Arapahoe County Makes No Representation Or Warranty As To The Accuracy Of This Base Map, And Assumes No Responsibility Or Liability To Any User. This Base Map Is Not A Legal Document. It Is Intended To Serve As An Aid In Graphic Representation Only.

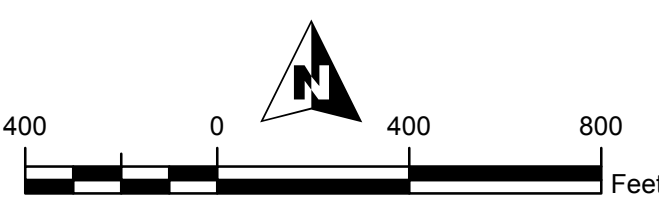

- Roads
- Parcels
- Subdivisions
- FDP/PDP
- Zoning
- Jurisdictions
- Airport Influence Area

Document Path: G:\DSIM\HE\MAPPING\GIS\Projects\Zoning\ZoningmapsBySection\1977-18\Zoning.mxd

	R68W	R67W	R66W	R65W	R64W	R63W	R62W	R61W	R60W	R59W	R58W	R57W
T4S	1971	1973	1975	1977	1979	1981	1983	1985	1987	1989	1991	1993
T5S	2077	2075	2073	2071	2069	2067	2065	2063	2061	2059	2057	2055